



South Beach Sewer Project Update

July 19, 2011

Dear South Beach Property Owners

Re: South Beach Sewer Project Update- July 19, 2011

This is the first of a series of communications the RM will be providing to you regarding the South Beach sewer project. Notices will be posted regarding the project on the Municipal Website, www.gimli.ca to provide information as it becomes available.

On October 22, 2010 the Manitoba Municipal Board gave formal approval to the South Beach Borrowing Authority By-Law 10-0012. At the November 17, 2010 Council Meeting, Council gave 2nd and 3rd reading to By-law 10-0012 authorizing the required borrowing for the South Beach Sewer Project. The Municipality has signed the Engineering Agreement for the project with JR Cousin Consultants. The Engineers have already completed the design of the system.

To assist with the construction of the project, property owners must identify the location of the sewer service line at their property line with a wooden stake marked "Sewer Connection" by September 6th, 2011 otherwise the engineers will make a determination for the location of the sewer service line based on the site layout and location of buildings. The chosen service location may be altered based on the location of the mainline, driveways and hydro poles. Consultation with a plumber is recommended to determine a suitable sewer service location at property line. The following information may be of assistance in determining your connection location:

- Sewage tanks cannot be directly connected to the sewer system and old tanks must be drained and then either removed, crushed and buried or filled with sand.
- Property owners must obtain their own contractor to complete the sewer service connection from the property line to the building; the contractor would then be required to apply for a sewer connection permit at a cost of \$ 100.00 to allow for the costs for Municipal staff to inspect the installation

You will be required to connect your residence to the sewer system by October 31st, 2012. Extensions to this deadline must be requested of and approved by Council. Extension Exceptions to the deadline will only be provided under exceptional circumstances.

The tender will be going out within the next few weeks. Once the tender is awarded the Municipality will be in a position to advise the property owners of the design costs and accurate timelines to complete the project. We are expecting to have the project set up for construction by early September with a targeted completion date of February for the underground works and the road restoration will be completed next spring.



South Beach Sewer Project Update

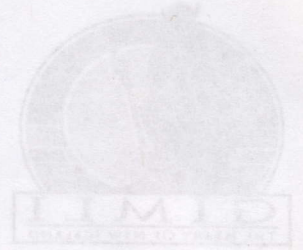

Once the project is completed the property owner must choose one of the following 2 options for the parcel levy payment:

- 1) A single payment currently estimated at \$13,088.33 to be made within 30 days of the completion of the project.
- 2) An annual levy for 20 years on the tax bill in the estimated amount of \$ 1,199.67.

The debenture financing rates are currently around 5.625 %. There is no provision under Municipal Financing procedures for property owners to prepay only a portion of the parcel levy or to finance it over a shorter time period. Property owners may want to consult with their financial institution to determine if it would be financially beneficial for them to borrow the monies to make payment under option 1 and then repay the loan on their own terms as this could save significant interests costs.

Please fill out the Service Location form on the next page and send it to The Municipal Office by September 13, 2011

Rural Municipality of Gimli
62 2nd Ave.
PO Box 1246
Gimli MB. ROC 1B0

Joann King CMMA
CAO
Gimli

NAME OF PROPERTY OWNER: _____

ADDRESS: _____

PHONE NUMBER: _____

LOT SIZE (IF KNOWN): _____

WHICH CONTRACTOR WILL BE CONNECTING THE SEWER SERVICE TO YOUR BUILDING? _____

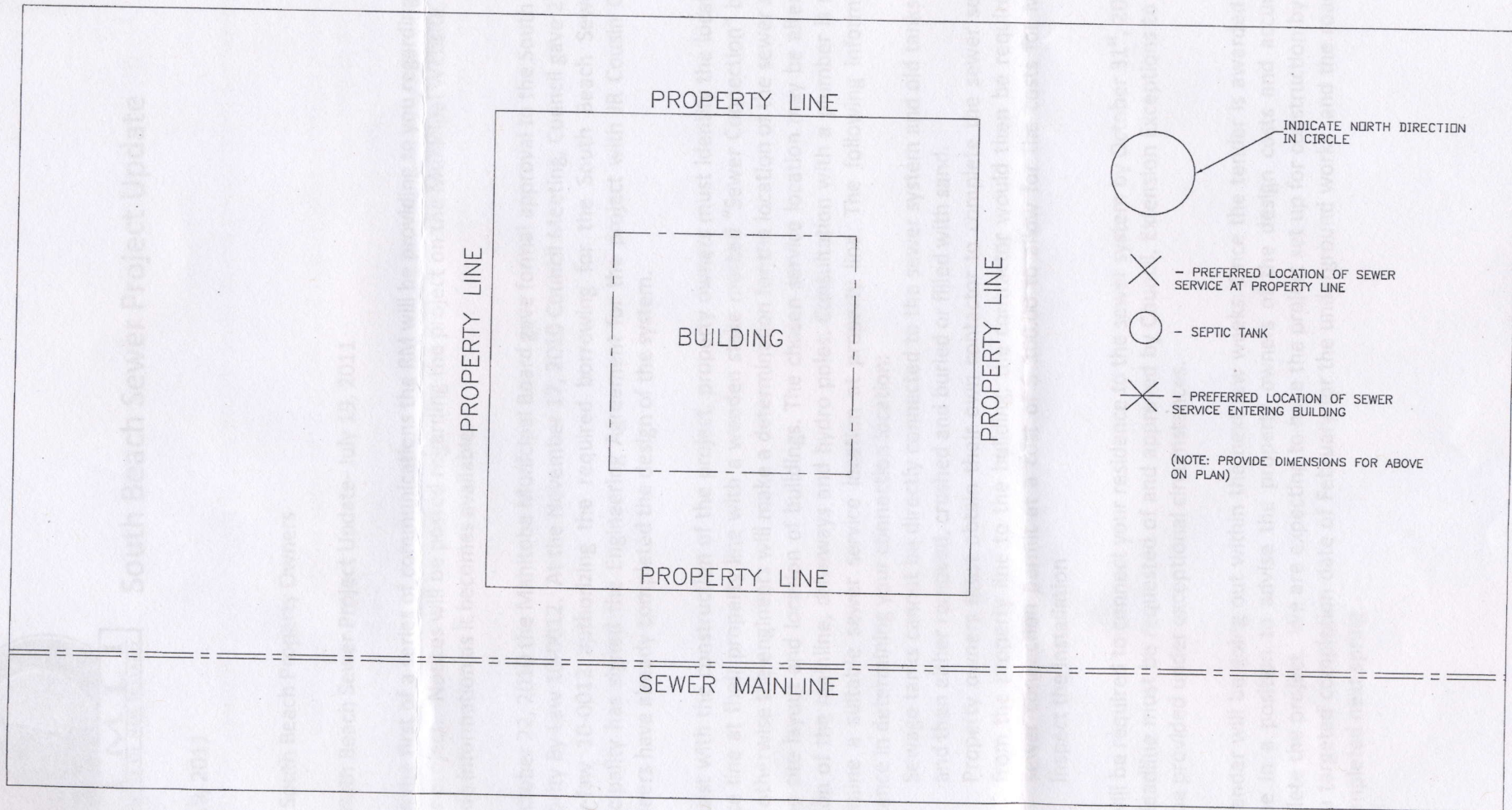

NOTES:
-INDICATE SEWER SERVICE LOCATION AT PROPERTY LINE. DISTANCE FROM PROPERTY LINES OR TWO BUILDING LOCATIONS ARE REQUIRED FOR ITEMS INDICATED ABOVE. PROPERTY LINE LOCATIONS ARE ASSUMED BASED ON HISTORIC USE.
-RE-SKETCH BUILDING IN PROPER LOCATION.
-INDICATE DRIVEWAY LOCATION.
-INDICATE SEPTIC TANK LOCATION.
-INDICATE NORTH BY DRAWING A DIRECTIONAL ARROW POINTING NORTH IN THE CIRCLE PROVIDED.
-IF THIS FORM IS NOT COMPLETED AND RETURNED TO THE R.M. OF GIMLI MUNICIPAL OFFICE, THE ENGINEER WILL DETERMINE THE SEWER SERVICE TEE LOCATION. THIS DECISION IS FINAL AND IRREVERSIBLE.